

Wayne RESA Bid Package T1 - Video Surveillance February 1, 2023 - Bid

Technology Designer

Barton Malow Builders
26500 American Drive
Southfield, MI 48034
248.436.5000
www.bartonmalow.com

GENERAL TECHNOLOGY NOTES:

- THESE DRAWINGS ARE DIAGRAMMATIC AND INDICATE THE GENERAL EXTENT OF THE WORK. CONTRACTORS SHALL PROVIDE ALL INCIDENTAL MATERIALS AND LABOR FOR A COMPLETE AND FULLY FUNCTIONAL SYSTEM.
- PRIOR TO BEGINNING WORK, CONTRACTORS ARE TO REVIEW BUILDING PLANS, INSTALLATION LOCATIONS, AND SITE CONDITIONS. NOTIFY THE TECHNOLOGY DESIGNER OF ANY CONDITIONS THAT MAY PREVENT PROPER INSTALLATION AND OPTIMAL PERFORMANCE OF THE SYSTEMS, VOID THE MANUFACTURERS WARRANTY, OR THAT CONFLICT WITH THE INTENT OF THE PROJECT. PROCEED WITH INSTALLATION ONLY AFTER UNSATISFACTORY CONDITIONS HAVE BEEN RESOLVED. THE CONTRACTOR IS RESPONSIBLE FOR ANY ADDITIONAL WORK RELATED TO CORRECTING UNREPORTED CONFLICTS AND ISSUES, AT NO ADDITIONAL COST TO THE OWNER.
- FIELD VERIFY LOCATIONS, CONDITIONS AND LENGTHS PRIOR TO INSTALLATION.
- CONTRACTOR IS REQUIRED TO PROVIDE THEIR OWN PENETRATIONS, SLEEVES, AND CORES THROUGH ALL WALLS AND FLOORS. ALL SLEEVES SHALL HAVE NYLON BUSHINGS.
- CONTRACTOR SHALL PROVIDE FIRESTOPPING ON PENETRATIONS PASSING THROUGH WALLS AND FLOORS IN WHICH THEY WORK.
- CONTRACTOR SHALL COORDINATE TELECOMMUNICATION ROOM LAYOUTS WITH BARTON MALOW AND ALL IMPACTED CONTRACTORS PRIOR TO INSTALLATION.
- CONTRACTOR SHALL COORDINATE ALL EQUIPMENT LOCATIONS AND ROUGH-IN REQUIREMENTS WITH BARTON MALOW AND ALL IMPACTED CONTRACTORS PRIOR TO INSTALLATIONS.
- CONTRACTOR SHALL PROVIDE FACEPLATES AND INSERTS FOR THEIR DEVICES.
- WHERE EXISTING DUAL-CHANNEL RACEWAY IS SHOWN, CONTRACTOR SHOULD NOT ASSUME THAT POWER AND LOW VOLTAGE SIDES ARE SHOWN ACCURATELY. CONTRACTOR MAY BE REQUIRED TO PROVIDE AND INSTALL INTERNAL CROSSOVER TO ROUTE LOW VOLTAGE CABLING ACROSS POWER CABLING.
- CONTRACTOR SHALL PROVIDE PROTECTIVE GUARDS ON THEIR DEVICES (LOCKS, PHONES, ACCESS POINTS, MOTION DETECTORS, ETC.) SUBJECT TO ABUSE IN GYMNASIUMS AND NATATORIUMS.
- PROVIDE SAFETY CABLE OR STRAP ATTACHED TO BUILDING STEEL FOR ALL CEILING MOUNTED DEVICES.

T2 SHEETS - FIBER INFRASTRUCTURE

FIBER INFRASTRUCTURE PROJECT NOTES:

- PROVIDE, INSTALL, TERMINATE, AND TEST 12-STRAND 50 MICRON SINGLE MODE ARMORED FIBER BETWEEN THE DEMARCATION POINT AND MDF, AND BETWEEN THE MDF AND EACH IDF. APPROXIMATE PATHWAYS SHOWN - FIELD VERIFY.
- USE LC CONNECTORS THROUGHOUT.
- PROVIDE AND INSTALL THE FOLLOWING FIBER PATCH PANELS:
 - MAF - 48 PORT
 - IDF A - 12 PORT
 - IDF C - 12 PORT
 - RESA ADMIN IDF - 12 PORT
 - DEMARC LOCATION - 12 PORT

T7 SHEETS - VIDEO SURVEILLANCE SYSTEM

SYMBOL STYLES & ABBREVIATIONS:

VIDEO SURVEILLANCE CAMERA. SHADING INDICATES DIRECTION OF VIEW, NOT COVERAGE

- SINGLE LENS / SENSOR**
- A2 2 MEGAPIXEL INDOOR / 2.0C-HSA-D1-IR | OUTDOOR: 2.0C-HSA-D01-IR
 - A4 4 MEGAPIXEL INDOOR / 6.0C-HSA-D1-IR | OUTDOOR: 4.0C-HSA-D01-IR
 - A6 6 MEGAPIXEL INDOOR / 6.0C-HSA-D1-IR | OUTDOOR: 6.0C-HSA-D01-IR
 - A8 8 MEGAPIXEL INDOOR / 8.0C-HSA-D1-IR | OUTDOOR: 8.0C-HSA-D01-IR
- TWO LENS / SENSOR**
- B5 8 MEGAPIXEL INDOOR / OUTDOOR: 6.0C-HSCH-D01-IR
- THREE LENS / SENSOR**
- C9 9 MEGAPIXEL INDOOR / OUTDOOR 180°: 9C-HAA-3MH-180 | 270°: 9C-HAA-3MH-270
 - C15 15 MEGAPIXEL INDOOR / OUTDOOR 180°: 15C-HAA-3MH-180 | 270°: 15C-HAA-3MH-270
 - C24 24 MEGAPIXEL INDOOR / OUTDOOR 180°: 24C-HAA-3MH-180 | 270°: 24C-HAA-3MH-270
- FOUR LENS / SENSOR**
- D12 12 MEGAPIXEL INDOOR / OUTDOOR 360°: 12C-H4A-4MH-360
 - D20 20 MEGAPIXEL INDOOR / OUTDOOR 360°: 20C-H4A-4MH-360

55" FLAT PANEL DISPLAY WITH OWNER PROVIDED. CONTRACTOR INSTALLED MINI PC, CEILING MOUNTED VIDEO SURVEILLANCE SYSTEM PROJECT NOTES:

- VIDEO SURVEILLANCE CONTRACTOR TO PROVIDE AND INSTALL CAT6 DATA CABLING, TERMINATION, AND TESTING FOR ALL CAMERA AND FLAT PANEL DISPLAY LOCATIONS AS NECESSARY.
- CONFIRM ALL MOUNTING LOCATIONS WITH TECHNOLOGY DESIGNER PRIOR TO INSTALLATION.
- REVIEW AND CONFIRM ALL CAMERA VIEWS AND SETTINGS WITH TECHNOLOGY DESIGNER AND OWNER PRIOR TO ACCEPTANCE, ADJUST AS NECESSARY.
- ALL EXTERIOR CAMERAS SHALL BE RATED FOR SUCH USE AND BE PROVIDED WITH HOUSING, HEATER, AND BLOWER AS NECESSARY TO OPERATE IN THE INTENDED CLIMATE.
- ALL EXTERIOR WALL CAMERAS SHALL BE DOME-STYLE AND BE MOUNTED WITH PENDANT ARMS.
- VIDEO SURVEILLANCE CONTRACTOR TO PROVIDE PATCH CABLES BETWEEN CAMERA AND DATA JACK SUPPLIED BY OTHERS. COORDINATE JACK LOCATIONS WITH DATA CONTRACTOR.
- THE FOLLOWING MONITORING STATIONS SHALL BE INCLUDED WITH THIS PROJECT. CONTRACTOR TO PROVIDE AND INSTALL A MONITOR (HD) OR DISPLAY (LHD) WITH APPROPRIATE MOUNTING HARDWARE. AN OWNER FURNISHED MINI PC, INTERCONNECTING CABLES AND PATCH CABLES. CONTRACTOR IS TO CONFIGURE SOFTWARE FOR VIEWING CAMERAS AS REQUESTED BY THE OWNER.
 - BURGER-BAYLOR ADMIN OFFICE A1: 55" DISPLAY, CEILING MOUNTED
 - BURGER-BAYLOR IDF #113: 43" DISPLAY, WALL MOUNTED
 - RESA FRONT DESK: 26" MONITOR, DESKTOP MOUNTED
 - RESA HALLWAY: 43" DISPLAY, WALL MOUNTED
 - TECHNOLOGY DIRECTORS OFFICE: 43" DISPLAY, CEILING MOUNTED

SHEET INDEX:

BURGER-BAYLOR	
T2.1	1st FLOOR COMPOSITE - FIBER INFRASTRUCTURE
T7.1	1st FLOOR COMPOSITE & SITE PLAN - VIDEO SURVEILLANCE SYSTEM

ISSUES & REVISIONS:

DATE	DESCRIPTION
02/01/2023	BID

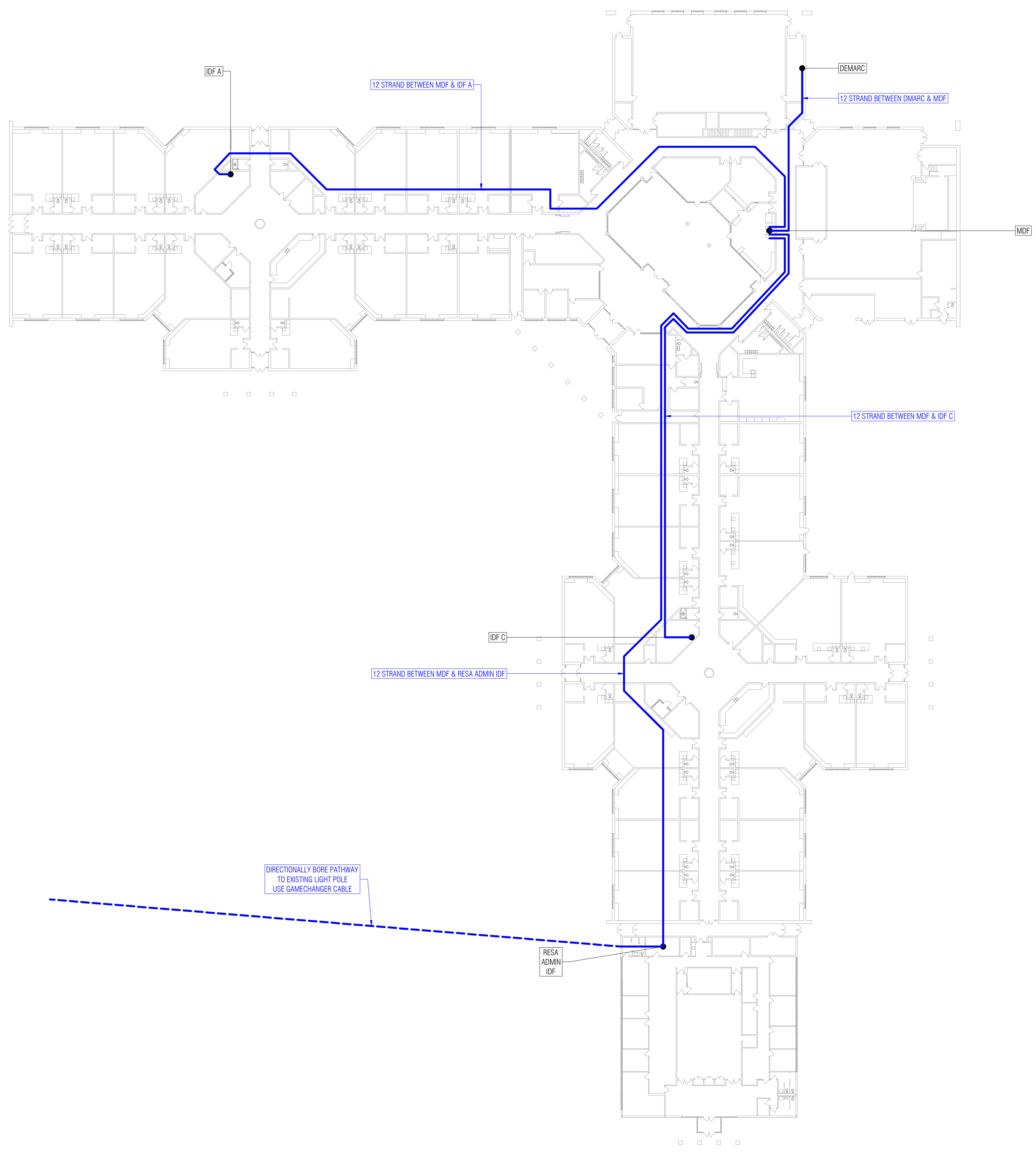

GENERAL TECHNOLOGY NOTES:

1. THESE DRAWINGS ARE DIAGRAMMATIC AND INDICATE THE GENERAL EXTENT OF THE WORK. CONTRACTORS SHALL PROVIDE ALL INCIDENTAL MATERIALS AND LABOR FOR A COMPLETE AND FULLY FUNCTIONAL SYSTEM.
2. PRIOR TO BEGINNING WORK, CONTRACTORS ARE TO REVIEW BUILDING PLANS, INSTALLATION LOCATIONS, AND SITE CONDITIONS. NOTIFY THE TECHNOLOGY DESIGNER OF ANY CONDITIONS THAT MAY PREVENT PROPER INSTALLATION AND OPTIMAL PERFORMANCE OF THE SYSTEMS. VOID THE MANUFACTURERS WARRANTY, OR THAT CONFLICT WITH THE INTENT OF THE PROJECT. PROCEED WITH INSTALLATION ONLY AFTER UNSATISFACTORY CONDITIONS HAVE BEEN RESOLVED. THE CONTRACTOR IS RESPONSIBLE FOR ANY ADDITIONAL WORK RELATED TO CORRECTING UNREPORTED CONFLICTS AND ISSUES, AT NO ADDITIONAL COST TO THE OWNER.
3. FIELD VERIFY LOCATIONS, CONDITIONS AND LENGTHS PRIOR TO INSTALLATION.
4. CONTRACTOR IS REQUIRED TO PROVIDE THEIR OWN PENETRATIONS, SLEEVES, AND CORES THROUGH ALL WALLS AND FLOORS. ALL SLEEVES SHALL HAVE NYLON BUSHINGS.
5. CONTRACTOR SHALL PROVIDE FIRESTOPPING ON PENETRATIONS PASSING THROUGH WALLS AND FLOORS IN WHICH THEY WORK.
6. CONTRACTOR SHALL COORDINATE TELECOMMUNICATION ROOM LAYOUTS WITH BARTON MALOW AND ALL IMPACTED CONTRACTORS PRIOR TO INSTALLATION.
7. CONTRACTOR SHALL COORDINATE ALL EQUIPMENT LOCATIONS AND ROUGH-IN REQUIREMENTS WITH BARTON MALOW AND ALL IMPACTED CONTRACTORS PRIOR TO INSTALLATIONS.
8. CONTRACTOR SHALL PROVIDE FACEPLATES AND INSERTS FOR THEIR DEVICES.
9. WHERE EXISTING DUAL-CHANNEL RACEWAY IS SHOWN, CONTRACTOR SHOULD NOT ASSUME THAT POWER AND LOW VOLTAGE SIDES ARE SHOWN ACCURATELY. CONTRACTOR MAY BE REQUIRED TO PROVIDE AND INSTALL INTERNAL CROSSOVER TO ROUTE LOW VOLTAGE CABLING ACROSS POWER CABLING.
10. CONTRACTOR SHALL PROVIDE PROTECTIVE GUARDS ON THEIR DEVICES (CLOCKS, PHONES, ACCESS POINTS, MOTION DETECTORS, ETC.) SUBJECT TO ABUSE IN GYMNASIUMS AND NATATORIUMS.
11. PROVIDE SAFETY CABLE OR STRAP ATTACHED TO BUILDING STEEL FOR ALL CEILING MOUNTED DEVICES.

T2 SHEETS - FIBER INFRASTRUCTURE

FIBER INFRASTRUCTURE PROJECT NOTES:

1. PROVIDE, INSTALL, TERMINATE, AND TEST 12-STRAND 50 MICRON SINGLE MODE ARMORED FIBER BETWEEN THE DEMARCATION POINT AND MDF, AND BETWEEN THE MDF AND EACH IDF. APPROXIMATE PATHWAYS SHOWN - FIELD VERIFY.
2. USE LC CONNECTORS THROUGHOUT.
3. PROVIDE AND INSTALL THE FOLLOWING FIBER PATCH PANELS:
 - 3.1. MDF - 48 PORT
 - 3.2. IDF A - 12 PORT
 - 3.3. IDF C - 12 PORT
 - 3.4. RESA ADMIN IDF - 12 PORT
 - 3.5. DEMARC LOCATION - 12 PORT



Barton Malow Builders
26500 American Drive
Southfield, MI 48034
348.436.5000
www.bartonmalow.com

Owner:



Wayne RESA
Wayne, Michigan

Project Number: TBD
Project Manager: Brian Jessie
Drawn By: Bill Dawson
Checked By: Brian Jessie

Issued For	Date
BID	02/01/2023

Key Plan:

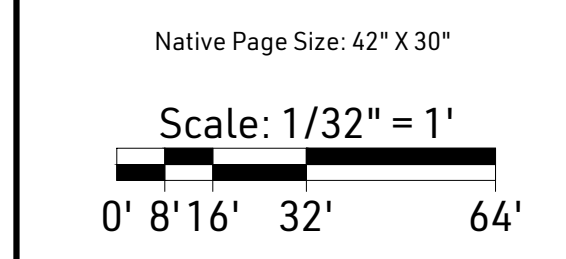

Bid Package T1
Video Surveillance

Burger-Baylor

1st Floor Composite
Fiber Infrastructure

T2.1

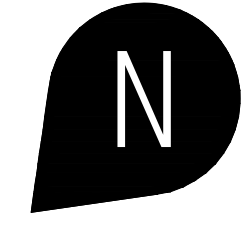



GENERAL TECHNOLOGY NOTES

- THESE DRAWINGS ARE DIAGRAMMATIC AND INDICATE THE GENERAL EXTENT OF THE WORK. CONTRACTORS SHALL PROVIDE ALL INCIDENTAL MATERIALS AND LABOR FOR A COMPLETE AND FULLY FUNCTIONAL SYSTEM.
- PRIOR TO BEGINNING WORK, CONTRACTORS ARE TO REVIEW BUILDING PLANS, INSTALLATION LOCATIONS, AND SITE CONDITIONS. NOTIFY THE TECHNOLOGY DESIGNER OF ANY CONDITIONS THAT MAY PREVENT PROPER INSTALLATION AND OPTIMAL PERFORMANCE OF THE SYSTEMS. VOID THE MANUFACTURER'S WARRANTY, OR THAT CONFLICT WITH THE INTENT OF THE PROJECT. PROCEED WITH INSTALLATION ONLY AFTER UNSATISFACTORY CONDITIONS HAVE BEEN RESOLVED. THE CONTRACTOR IS RESPONSIBLE FOR ANY ADDITIONAL WORK RELATED TO CORRECTING UNREPORTED CONFLICTS AND ISSUES, AT NO ADDITIONAL COST TO THE OWNER.
- FIELD VERIFY LOCATIONS, CONDITIONS AND LENGTHS PRIOR TO INSTALLATION.
- CONTRACTOR IS REQUIRED TO PROVIDE THEIR OWN PENETRATIONS, SLEEVES, AND CORES THROUGH ALL WALLS AND FLOORS. ALL SLEEVES SHALL HAVE NYLON BUSHINGS.
- CONTRACTOR SHALL PROVIDE FIRESTOPPING ON PENETRATIONS PASSING THROUGH WALLS AND FLOORS IN WHICH THEY WORK.
- CONTRACTOR SHALL COORDINATE TELECOMMUNICATION ROOM LAYOUTS WITH BARTON MALOW AND ALL IMPACTED CONTRACTORS PRIOR TO INSTALLATION.
- CONTRACTOR SHALL COORDINATE ALL EQUIPMENT LOCATIONS AND ROUGH-IN REQUIREMENTS WITH BARTON MALOW AND ALL IMPACTED CONTRACTORS PRIOR TO INSTALLATIONS.
- CONTRACTOR SHALL PROVIDE FACEPLATES AND INSERTS FOR THEIR DEVICES.
- WHERE EXISTING DUAL-CHANNEL RACEWAY IS SHOWN, CONTRACTOR SHOULD NOT ASSUME THAT POWER AND LOW VOLTAGE SIDES ARE SHOWN ACCURATELY. CONTRACTOR MAY BE REQUIRED TO PROVIDE AND INSTALL INTERNAL CROSSOVER TO ROUTE LOW VOLTAGE CABLING ACROSS POWER CABLING.
- CONTRACTOR SHALL PROVIDE PROTECTIVE GUARDS ON THEIR DEVICES (CLOCKS, PHONES, ACCESS POINTS, MOTION DETECTORS, ETC.) SUBJECT TO ABUSE IN GYMNASIUMS AND NATATORIUMS.
- PROVIDE SAFETY CABLE OR STRAP ATTACHED TO BUILDING STEEL FOR ALL CEILING MOUNTED DEVICES.

T7 SHEETS - VIDEO SURVEILLANCE SYSTEM

SYMBOL STYLES & ABBREVIATIONS

- C** VIDEO SURVEILLANCE CAMERA, SHADING INDICATES DIRECTION OF VIEW, NOT COVERAGE
- SINGLE LENS / SENSOR**
- A2 2 MEGAPIXEL INDOOR / 2.0C-HSA-D1-IR | OUTDOOR: 2.0C-HSA-D01-IR
- A4 4 MEGAPIXEL INDOOR / 4.0C-HSA-D1-IR | OUTDOOR: 4.0C-HSA-D01-IR
- A6 6 MEGAPIXEL INDOOR / 6.0C-HSA-D1-IR | OUTDOOR: 6.0C-HSA-D01-IR
- A8 8 MEGAPIXEL INDOOR / 8.0C-HSA-D1-IR | OUTDOOR: 8.0C-HSA-D01-IR
- TWO LENS / SENSOR**
- B6 6 MEGAPIXEL INDOOR / OUTDOOR: 6.0C-H5DH-D01-IR
- THREE LENS / SENSOR**
- C9 9 MEGAPIXEL INDOOR / OUTDOOR 180°: 9C-HA-3MH-180 | 270°: 9C-HA-3MH-270
- C15 15 MEGAPIXEL INDOOR / OUTDOOR 180°: 15C-HA-3MH-180 | 270°: 15C-HA-3MH-270
- C24 24 MEGAPIXEL INDOOR / OUTDOOR 180°: 24C-HA-3MH-180 | 270°: 24C-HA-3MH-270
- FOUR LENS / SENSOR**
- D12 12 MEGAPIXEL INDOOR / OUTDOOR 360°: 12C-HA-4MH-360
- D20 20 MEGAPIXEL INDOOR / OUTDOOR 360°: 20C-HA-4MH-360
- P** 55" FLAT PANEL DISPLAY WITH OWNER-PROVIDED. CONTRACTOR INSTALLED MINI PC, CEILING MOUNTED VIDEO SURVEILLANCE SYSTEM PROJECT NOTES:

- VIDEO SURVEILLANCE CONTRACTOR TO PROVIDE AND INSTALL DATA CABLING, TERMINATION, AND TESTING FOR ALL CAMERA AND FLAT PANEL DISPLAY LOCATIONS AS NECESSARY.
- CONFIRM ALL MOUNTING LOCATIONS WITH TECHNOLOGY DESIGNER PRIOR TO INSTALLATION.
- REVIEW AND CONFIRM ALL CAMERA VIEWS AND SETTINGS WITH TECHNOLOGY DESIGNER AND OWNER PRIOR TO ACCEPTANCE. ADJUST AS NECESSARY.
- ALL EXTERIOR CAMERAS SHALL BE RATED FOR SUCH USE AND BE PROVIDED WITH HOUSING, HEATER, AND BLOWER AS NECESSARY TO OPERATE IN THE INTENDED CLIMATE.
- ALL EXTERIOR WALL CAMERAS SHALL BE DOME-STYLE AND BE MOUNTED WITH PENDANT ARMS.
- VIDEO SURVEILLANCE CONTRACTOR TO PROVIDE PATCH CABLES BETWEEN CAMERA AND DATA JACK SUPPLIED BY OTHERS. COORDINATE JACK LOCATIONS WITH DATA CONTRACTOR.
- THE FOLLOWING MONITORING STATIONS SHALL BE INCLUDED WITH THIS PROJECT. CONTRACTOR TO PROVIDE AND INSTALL A MONITOR (HD) OR DISPLAY (LHD) WITH APPROPRIATE MOUNTING HARDWARE. AN OWNER-FURNISHED MINI PC, INTERCONNECTING CABLES AND PATCH CABLES. CONTRACTOR IS TO CONFIGURE SOFTWARE FOR VIEWING CAMERAS AS REQUESTED BY THE OWNER.
 - BURGER-BAYLOR ADMIN OFFICE A1, 55" DISPLAY, CEILING MOUNTED
 - BURGER-BAYLOR MDF E113, 43" DISPLAY, WALL MOUNTED
 - RESA FRONT DESK, 28" MONITOR, DESKTOP MOUNTED
 - RESA HALLWAY, 43" DISPLAY, WALL MOUNTED
 - TECHNOLOGY DIRECTORS OFFICE, 43" DISPLAY, CEILING MOUNTED



Barton Malow Builders
26500 American Drive
Southfield, MI 48034
348.436.5000
www.bartonmalow.com

Owner:



Wayne RESA
Wayne, Michigan

Project Number: TBD
Project Manager: Brian Jessie
Drawn By: Bill Dawson
Checked By: Brian Jessie

Issued For	Date
BID	02/01/2023

Key Plan:

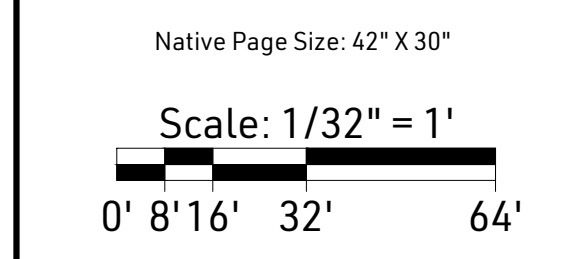

Bid Package T1
Video Surveillance

Burger-Baylor

1st Floor Composite & Site Plan
Video Surveillance System

T7.1

